

Job No.: 136236.DC.10  
Tech: 052593EA  
Working Dir: H:\USERS\GALMSTRO\  
Date: 02-11-1998  
Time: 3:12:03p  
Drawing: sht-08.dwg

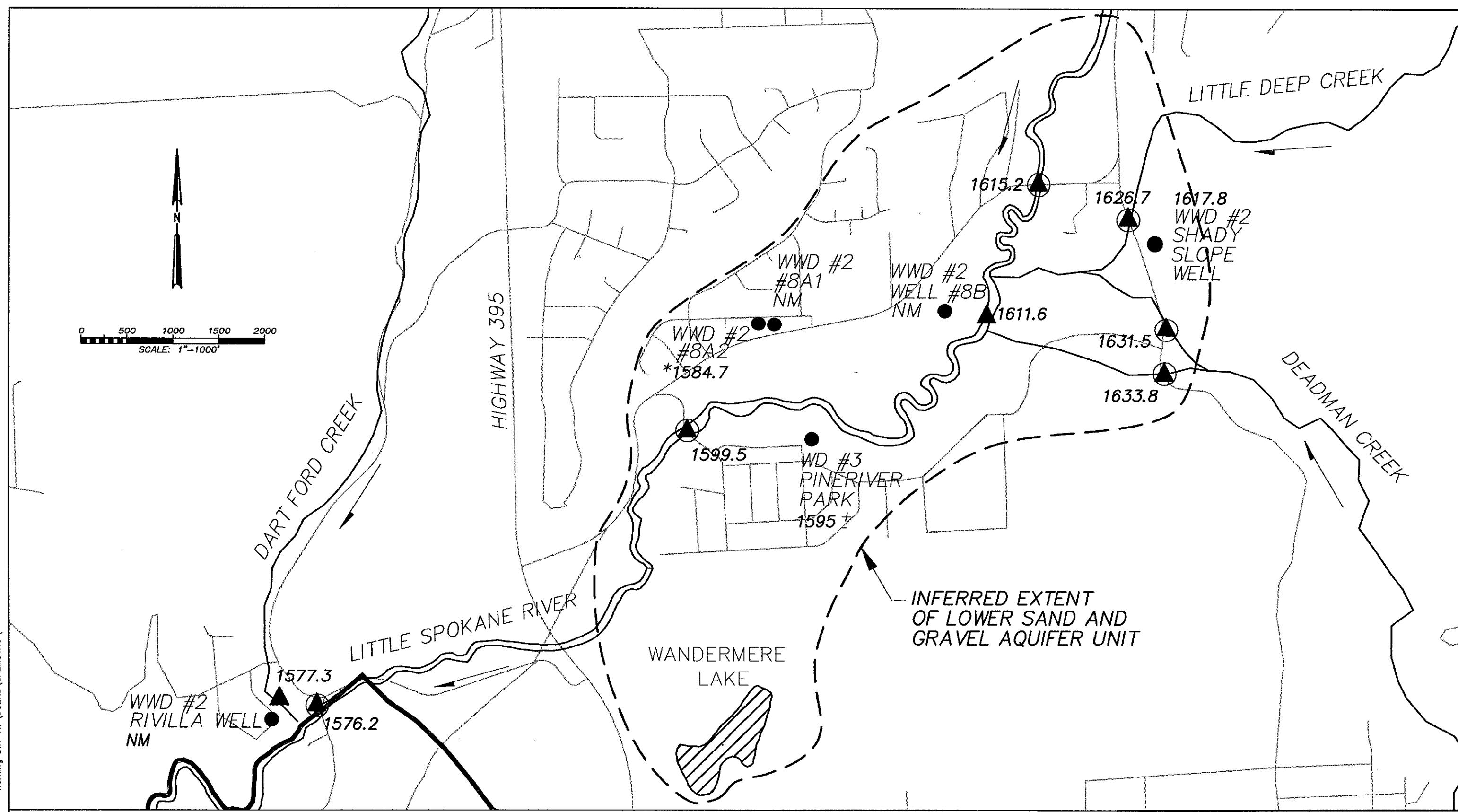

**LEGEND:**

- ▲ 1615.2 RIVER LEVEL AT BRIDGE CROSSING ON 5/21/97.
- ▲ 1599.5 RIVER STAFF GAUGE AND WATER LEVEL ELEVATION ON 5/21/97.
- 1617.8 WATER SUPPLY WELL AND WATER LEVEL ELEVATION ON 5/21/97.

**NOTES:**

WWD = WHITWORTH WATER DISTRICT #2  
WD#3 = SPOKANE COUNTY WATER DISTRICT #3  
NM = WATER LEVEL NOT MEASURED DUE TO ACCESS CONSTRAINTS  
\* DENOTES PUMPING WATER LEVEL

**FIGURE 2-14**  
**LITTLE SPOKANE RIVER**  
**Basin Data Collection Network**  
**and Water Levels**